

# systemtronic datasheet BALDAS

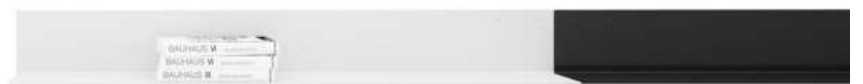

General description:

Modular shelves of linear aesthetics in vertical and horizontal disposition, which allow the free composition of them to suit the needs of each space. Produced in aluminum.

Designer: Víctor Carrasco.

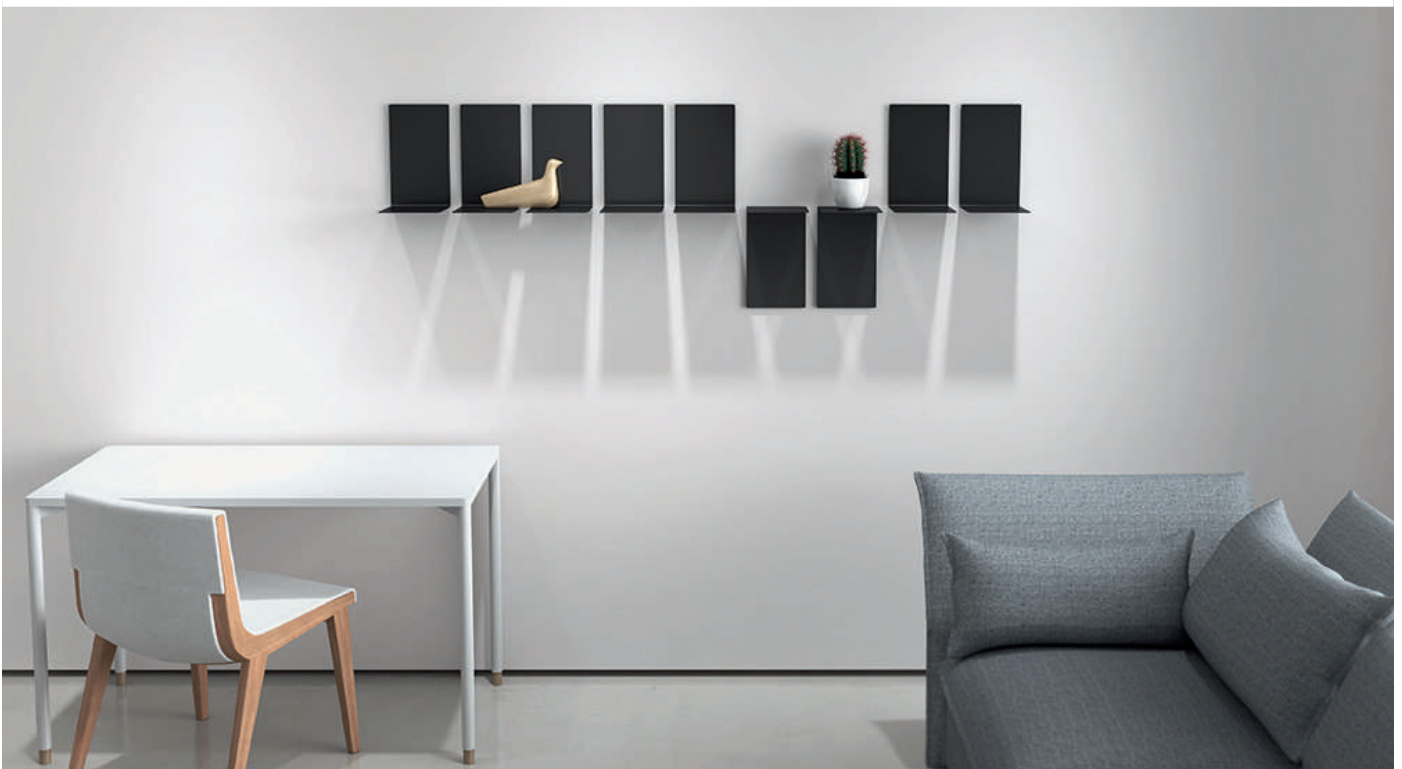

**Technical description:**



-The shelves consist of levelling supports that, once already perforated in the wall, allow its adjustment in a maximum margin of 12mm vertically to ensure that the shelf is straightened to the desired height.

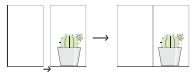

-With the supports already anchored, the shelf can be adjusted by moving it a few millimetres to the right or left, to attach it to the adjoining shelf, or on the other hand, if desired, to leave space between them.



-In case of accidents, such as it could be a hit, the shelves have been designed with a counter-system that prevents the shelves from being removed once fixed.

Material: Aluminum sheet

**Dimensions:**

- Balda\_S: 180x190x310mm 7.08x7.48x12.2 "
- Balda\_R: 180x190x310mm 7.08x7.48x12.2 "
- Balda\_M: 995x190x120mm 39.17x7.48x4.72 "

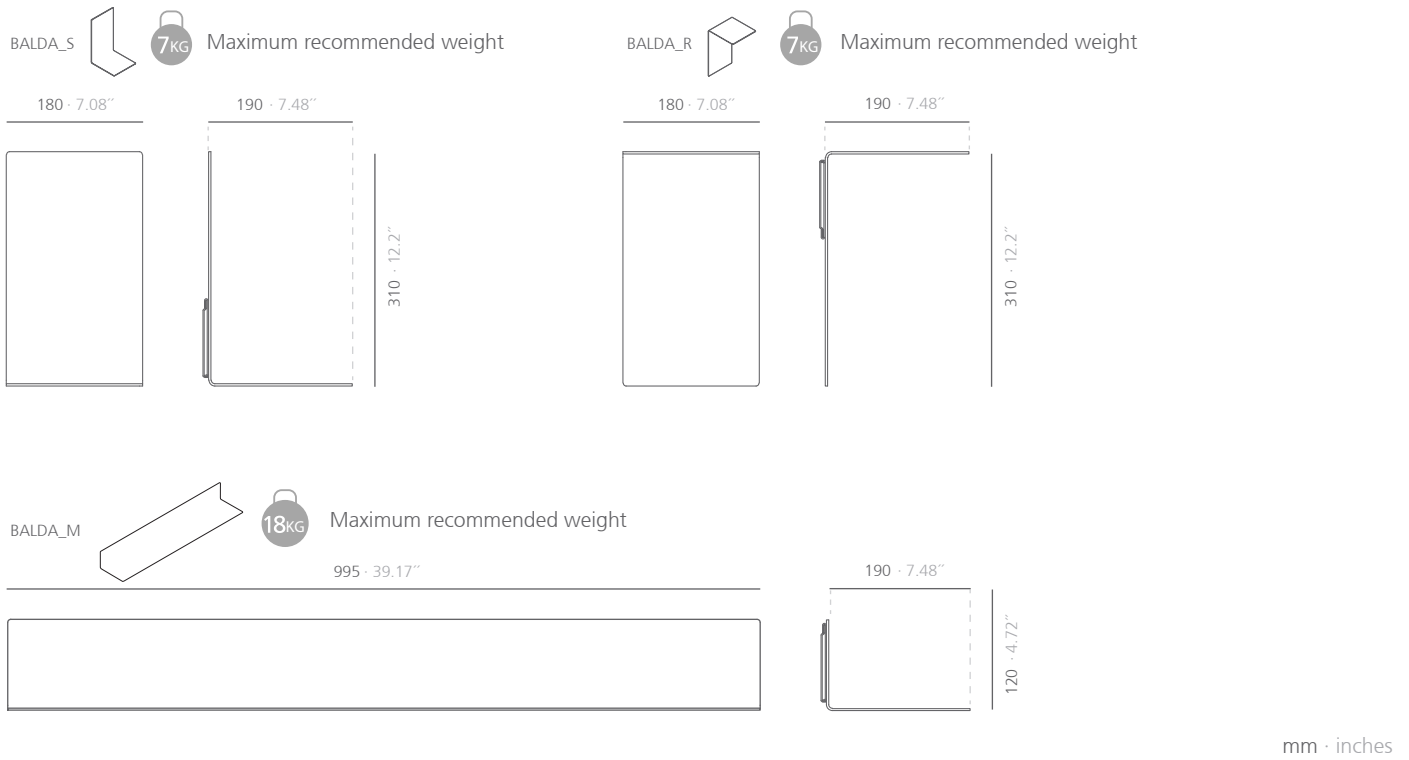

**Finishes:**



Consult for special dimensions or any other modification.

**Maintenance:**

-Polyester Paint:

For dry dirt (dust), use a damp cloth. For greasy/oily stains (fingerprints), wipe with a sponge with water and dishwashing liquid. Rinse with a damp cloth. Avoid using products containing solvents and/or pure ethyl alcohol.

**Sustainability:**

Manufacturing materials are 100% recyclable. The used paints do not contain solvents, do not consume water and do not generate emissions or waste. The result is a lower environmental impact.

Example of compositions:

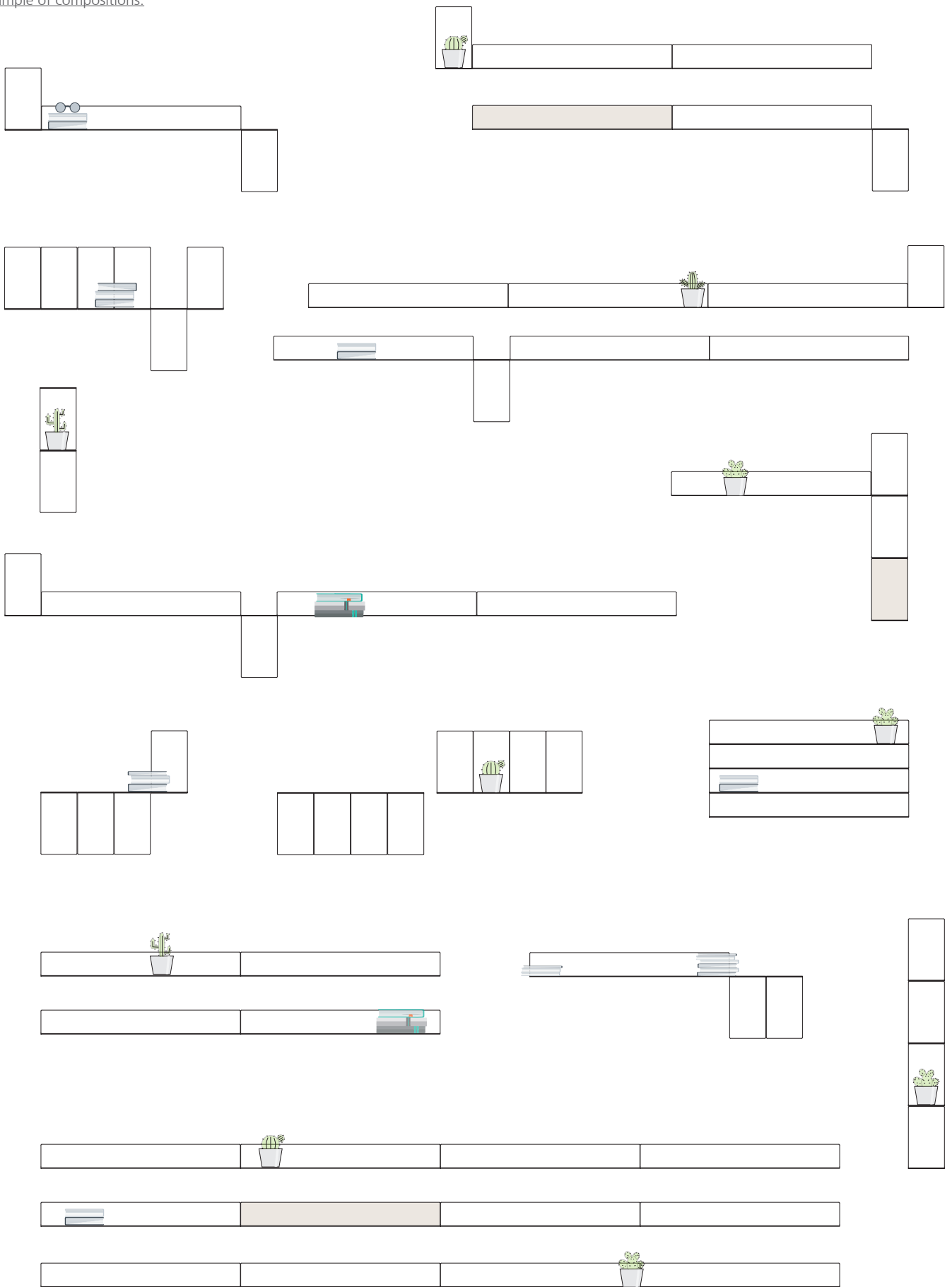

Balda R Assembly:

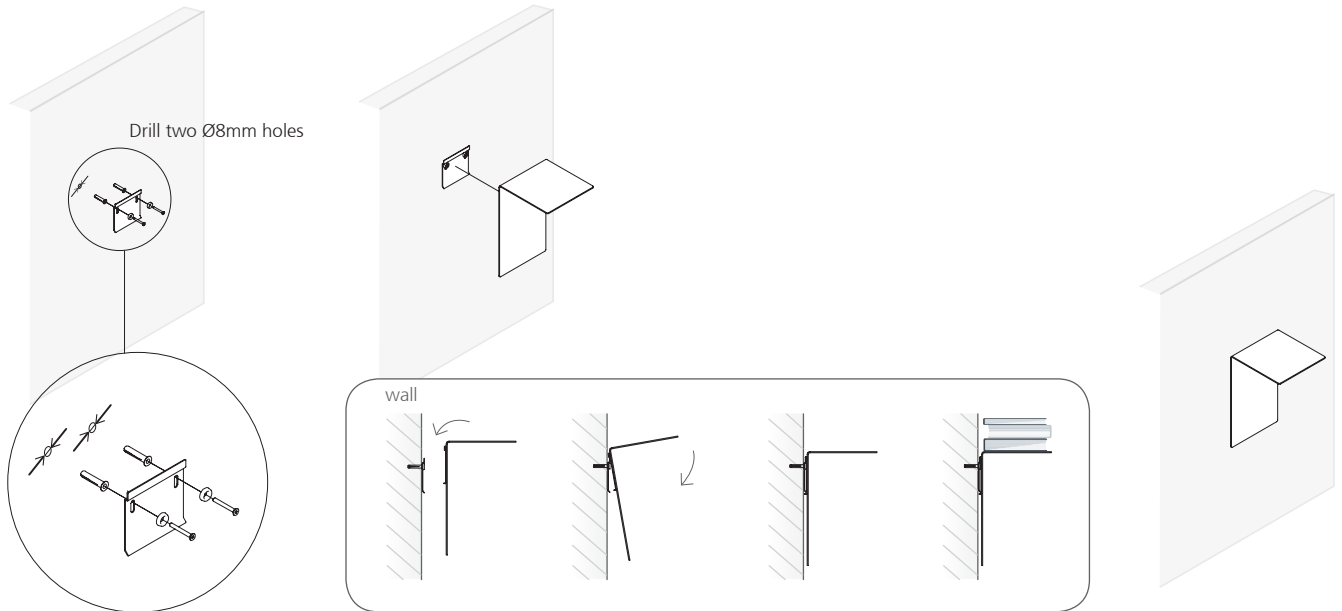

Balda S Assembly:

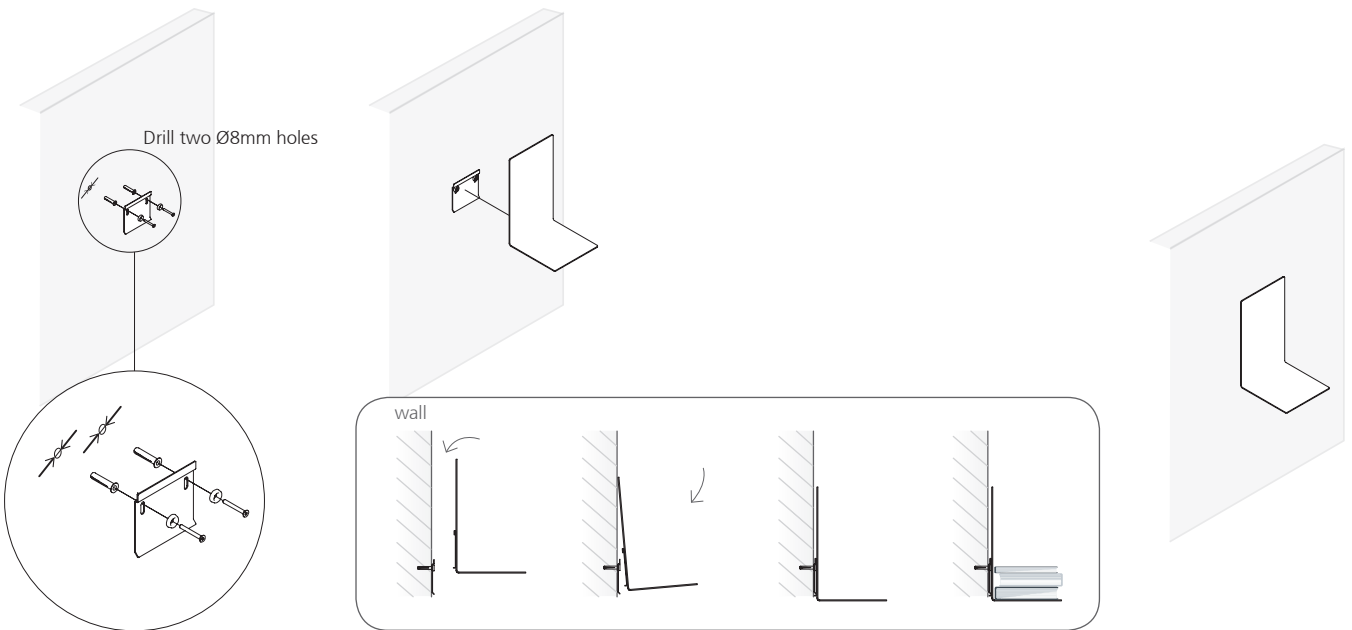

Balda M Assembly:

